

Roger Gill

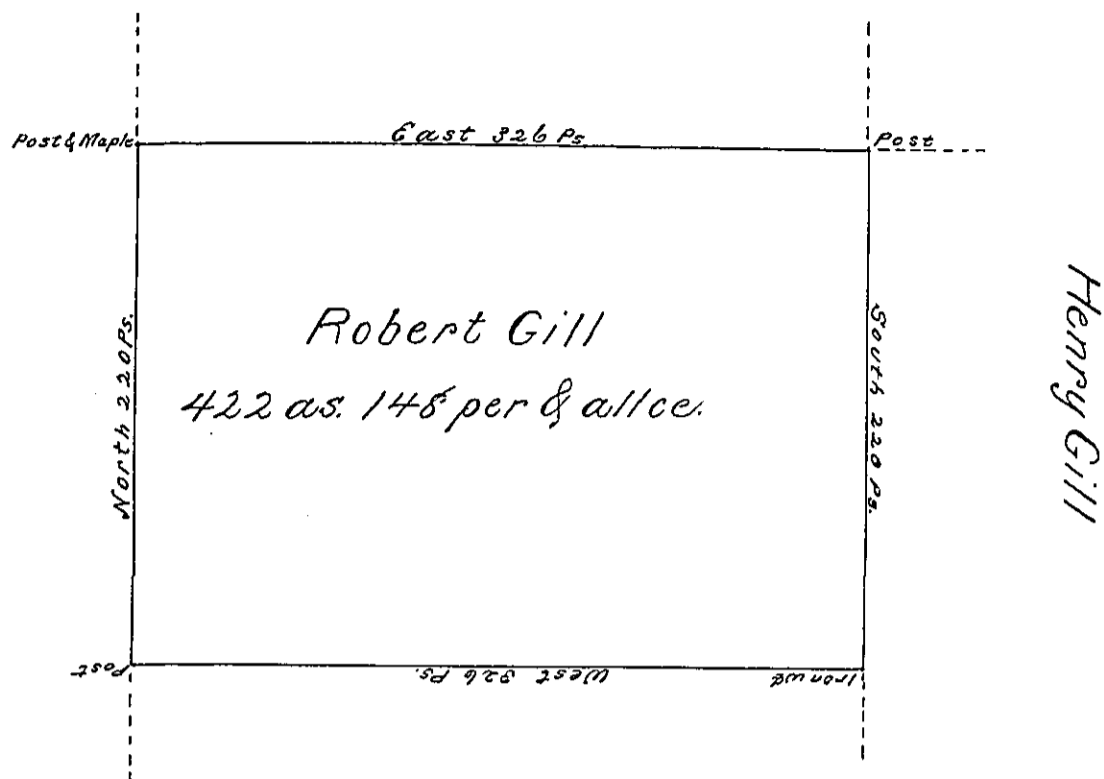

Situate on the East side of French Creek in
 Allegheny County containing 422 as. & 148 perches and
 allowance of Six pcent for Roads &c. Surveyed the
 20th. Day of June 1790 In pursuance of a Warrant
 dated the 10th. Day of Apl. 1793

Wm. Power Esq. Sr.
 To Danl. Brodhead Esquire
 Surveyor General

IN TESTIMONY that the above is a copy of the original remaining on file in
 the Department of Internal Affairs of Pennsylvania, made
 conformably to an Act of Assembly approved the 16th day of
 February, 1833, I have hereunto set my Hand and caused
 the Seal of said Department to be affixed at Harrisburg,
 this third day of October 1897

James W. Latta
 Secretary of Internal Affairs,